



Advisory Neighborhood Commission 1C

PO Box 21009, NW, Washington, DC 20009

www.anc1c.org

Representing Adams Morgan

Commissioners:

July 19, 2013

Brian Hart (1C01)

Marty Davis (1C02)

Ted Guthrie (1C03)

Gabriela Mossi (1C04)

Elham Dehbozorgi (1C05)

Billy Simpson (1C06)

Wilson Reynolds (1C07)

Jimmy Rock (1C08)

District Department of Transportation
Public Space Management Branch
1100 4th Street S.W., 2nd Floor
Washington, DC 20024

Re: Sidewalk Café Application for 2412 18th Street, N.W. (DDOT tracking #83203)

Dear Public Space Committee:

I am writing on behalf of ANC 1C. At its duly-noticed July 10, 2013 meeting, with a quorum present, ANC 1C approved the following resolution supporting the application for a sidewalk café at 2412 18th Street, N.W. (DDOT tracking #83203):

BE IT RESOLVED that ANC 1C supports the proposed sidewalk cafe at New Orleans Cafe, as detailed in the attached drawing, as consistent with ANC 1C's guidelines for sidewalk cafes on 18th Street, N.W., and ANC 1C requests that the Public Space Committee of DDOT grant New Orleans Cafe's application for a permit to operate this proposed sidewalk cafe.

Best Regards,

Jimmy R. Rock

Jimmy Rock
Commissioner, ANC 1C08
Chair, Planning, Zoning and Transportation Committee, ANC 1C
Jimmyrockanc1C08@gmail.com

(enclosure)

TOP VIEW
 OUTSIDE CAFE
 2412 18 STREET N.W.

DANCE ALLEY WAY

NEW ORLEANS CAFE
 SEATING 4

SCALE 1/2" = 1'
 DRAWING BY
 BARBARA PERDUE
 B.S. IN CIVIL ENGR.

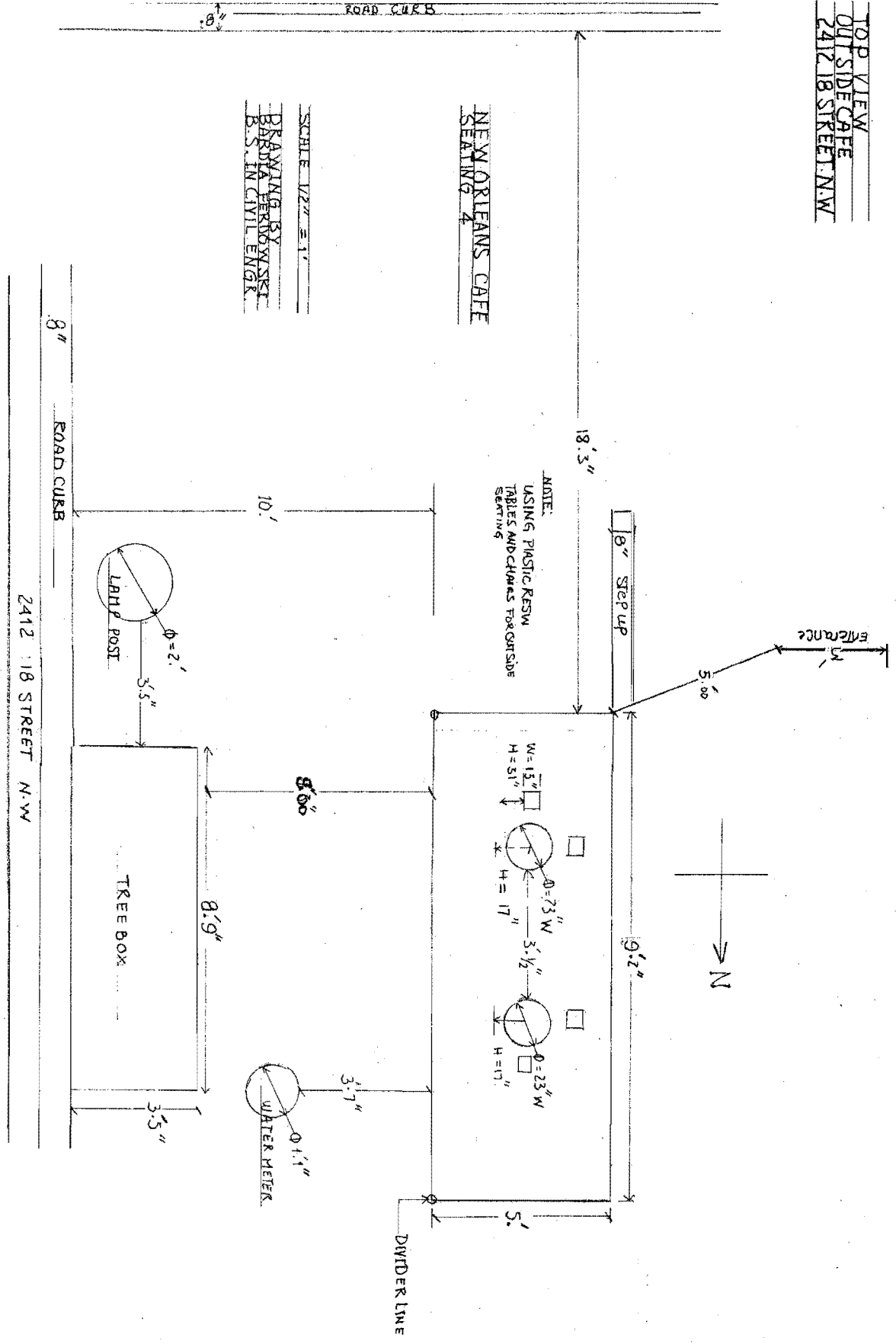

2412 18 STREET N.W.

8" ROAD CURB

8"

DIVER LINE

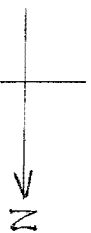

ENTRANCE
 5'00"

18'3"

9'2"

8" STEP UP

NOTE:
 USING PLASTIC RESIN
 TABLES AND CHAIRS FOR OUTSIDE
 SEATING

W = 15" H = 31"
 W = 13" H = 17"
 W = 33" H = 17"
 W = 23" H = 11"
 W = 17" H = 17"

10'

8'00"

3'7"

WATER METER
 1'1"

8'9"

LAMP POST
 2'

3'5"

TREE BOX

3'5"

8" ROAD CURB

8"